

RVG

WIND VANE SELF STEERING SYSTEM

LEVER HOUSING AND LEVER SHAFT - ASSEMBLY REFERENCE DRAWINGS

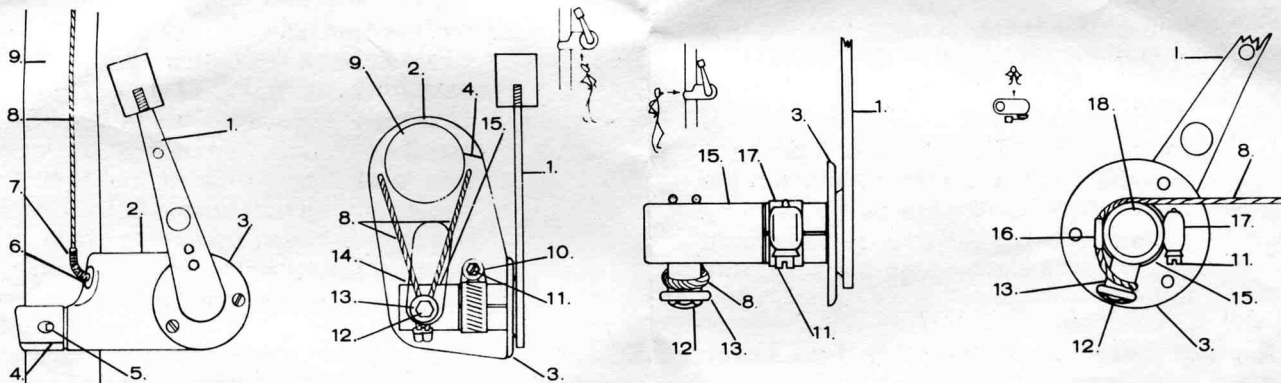

LEVER SHAFT-ASSEMBLY

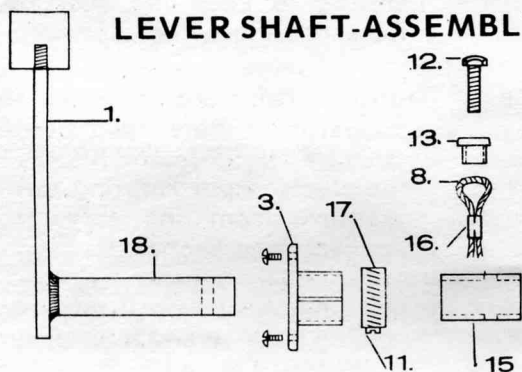

Identification numbers on housing and shaft assembly drawings are correlated.

- | | |
|---|---|
| 1. Lever | 11. Brake-clamp screw |
| 2. Lever housing | 12. Cable-holding bolt
(1/4" x 1"
S/S hex head) |
| 3. Mounting-plate | 13. Cable-holding bushing |
| 4. Housing-clamp slot | 14. Assembly hole |
| 5. Housing-clamp bolt
(1/4" x 1"
S/S socket head) | 15. Shaft bushing |
| 6. Cable bushing | 16. Swedging clamp |
| 7. Cable sleeve | 17. Brake-clamp |
| 8. Clutch cable | 18. Shaft |
| 9. Main shaft | |
| 10. Adjustment hole | |

RVG CLUTCH LEVER ASSEMBLY INSTRUCTIONS

A. To Gain Access To Lever Housing

IMPORTANT: Before changing the position of the lever housing (2) in order to gain access to its underside, mark upper or lower housing edge and location of housing-clamp slot (4) on the main shaft (9) so that the housing's longitudinal and lateral positions relative to the main shaft can be re-established. If the housing is not brought back to its original lateral position, the trim tab linkage will be misaligned and the RVG will not steer properly. If the housing is not brought back to its original longitudinal position, the clutch may not disengage.

- Engage clutch (lever up toward main shaft as far as it will go) to release tension on clutch cables (8).
- Loosen, but do not remove, housing-clamp bolt (5).
- Turn housing to one side and slide slightly upward.
- Retighten housing-clamp bolt to keep housing from shifting while disassembly and assembly is in process.

B. To Remove Lever Shaft-assembly from Lever Housing

- Through adjustment hole (10) in underside of housing, loosen, but do not remove, brake-clamp screw (11).

INTERNATIONAL MARINE MANUFACTURING CORP.

8895 SW 129TH STREET
MIAMI, FLORIDA 33176
(305) 255-3939

CABLE: RVGMIAMI

TELEX: 51-9660